

vtech®

Instruction Manual

Swipe & Learn Laptop



VTech understands that a child's needs and abilities change as they grow and with that in mind we develop our toys to teach and entertain at just the right level...

vtech Baby

Toys that will stimulate their interest in different textures, sounds and colours

I am...

...responding to colours, sounds and textures

...understanding cause and effect

...learning to touch, reach, grasp, sit-up, crawl and toddle

Birth-36 months



Pre-School

Interactive toys to develop their imagination and encourage language development

I want...

...to get ready for school by starting to learn the alphabet and counting

...my learning to be as fun, easy and exciting as can be

...to show my creativity with drawing and music so my whole brain develops

3-6 years



Electronic Learning Computers

Cool, aspirational and inspiring computers for curriculum related learning

I need...

...challenging activities that can keep pace with my growing mind

...intelligent technology that adapts to my level of learning

...National Curriculum based content to support what I'm learning at school

4-10 years



To learn more about this and other VTech® products, visit www.vtech.co.uk

INTRODUCTION

Slide into fun play with the **VTech®Swipe & Learn Laptop**. Get busy learning about letters, objects, numbers, weather, and more. Move the slider to music mode to play with the animal band.

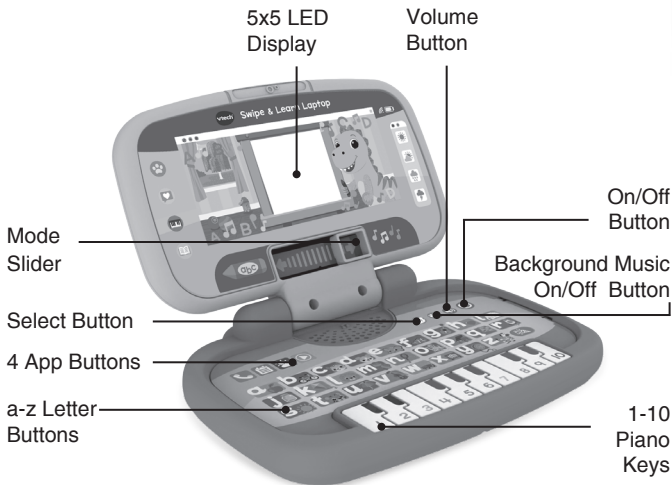

INCLUDED IN THIS PACKAGE

- One VTech® Swipe & Learn Laptop
- Quick Start Guide

WARNING

All packing materials such as tape, plastic sheets, packaging locks, removable tags, cable ties, cords and packaging screws are not part of this toy and should be discarded for your child's safety.

NOTE

Please save this Instruction Manual as it contains important information.

Unlock the packaging locks:

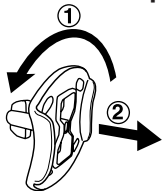

- ① Rotate the packaging lock 90 degrees anticlockwise.
- ② Pull out the packaging lock.

GETTING STARTED

BATTERY REMOVAL AND INSTALLATION

1. Make sure the unit is turned **OFF**.
2. Locate the battery cover on the back of the unit. Use a screwdriver to loosen the screw. Then, open the cover.
3. If used or spent batteries are present, remove these batteries from the unit by pulling up on one end of each battery.
4. Install 3 new AA (AM-3/LR6) batteries following the diagram inside the battery box. (The use of new alkaline batteries is recommended for maximum performance).
5. Replace the battery cover and tighten the screw to secure the battery cover.

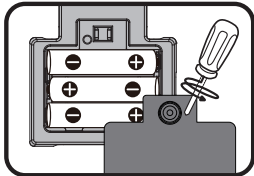

WARNING:

Adult assembly required for battery installation.

Keep batteries out of reach of children.

IMPORTANT: BATTERY INFORMATION

- Insert batteries with the correct polarity (+ and -).
- Do not mix old and new batteries.
- Do not mix alkaline, standard (carbon-zinc) or rechargeable batteries.
- Only batteries of the same or equivalent type as recommended are to be used.
- Do not short-circuit the supply terminals.
- Remove batteries during long periods of non-use.
- Remove exhausted batteries from the toy.
- Dispose of batteries safely. Do not dispose of batteries in fire.

RECHARGEABLE BATTERIES:

- Remove rechargeable batteries (if removable) from toy before charging.
- Rechargeable batteries are only to be charged under adult supervision.
- Do not charge non-rechargeable batteries.

Disposal of batteries and product



The crossed-out wheellie bin symbols on products and batteries, or on their respective packaging, indicates they must not be disposed of in domestic waste as they contain substances that can be damaging to the environment and human health.



The chemical symbols Hg, Cd or Pb, where marked, indicate that the battery contains more than the specified value of mercury (Hg), cadmium (Cd) or lead (Pb) set out in the Batteries and Accumulators Regulation.

The solid bar indicates that the product was placed on the market after 13th August, 2005.

 Please dispose of your product and batteries responsibly.

In the UK, give this toy a second life by disposing of it at a small electricals collection point* so all of its materials can be recycled.

Learn more at:

www.vtech.co.uk/recycle

www.vtech.com.au/sustainability

* Visit www.recyclenow.com to see a list of collection points near you.

PRODUCT FEATURES

1. ON/OFF BUTTON

Press this button to turn the laptop on and off.

2. MODE SLIDER

Slide this slider to the left to enter the Learning Fun Mode. Slide this slider to the right to enter the Music Time Mode.

3. SELECT BUTTON

In the Learning Fun mode, press this button to hear a learning phrase randomly.

In the Music Time mode, press this button to change the instrument sound or for a melody to the instrument tune.

4. BACKGROUND MUSIC ON/OFF BUTTON

Press this button to turn the background music on or off.

5. 4 APP BUTTONS

Press the app buttons to learn greetings, daily life rules, weather, or listen to the sing along songs.

6. SURPRISE BUTTON

Press this button to play fun sounds and light patterns.

7. LETTER BUTTONS

Press the letter buttons to learn letters, phonics, objects or play a melody.



8. PIANO KEYS

Press the piano keys to learn numbers and counting, or play a music note.

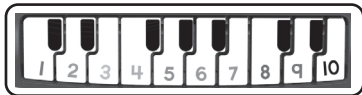

9. AUTOMATIC SHUT-OFF

To preserve battery life, the Swipe & Learn Laptop will automatically power down after about 1 minute without input. The unit can be turned on again by pressing the On/Off button. The unit will automatically turn off when the batteries are low on power.

NOTE

If the LED lights fade during play, please install a new set of batteries.

ACTIVITIES

1. Learning Fun mode

Press the letter buttons to learn letters, phonics and objects.

Press the **Piano Keys** to learn numbers & counting.

Press the **Select Button** to randomly hear the related phrases of letters or numbers.

Press the **Surprise Button** to play fun sounds and led patterns.



4 Apps:

Who's Calling Button

Press this button to learn greetings.

Events Button

Hear about daily life rules.

Weather Button

Hear some weather features and tips.

Sing-Along Songs Button

Press to hear the sing-along songs.

2. Music Time mode

Press the letter buttons to hear 26 melodies.

Press the **Piano Keys** to create your own music or jam into the melody.

Press the **Select Button** to change the instrument sounds.

Press the **Surprise Button** to play fun sounds and led patterns.



4 Apps:

Who's Calling Button

Press this button to listen to the animals chat.

Events Button

Reminds you of special events.

Weather Button

Learn the weather forecast.

Sing-Along Songs Button

Press to hear the sing along songs.

Song lyrics:

Song 1: Learning new things - one, two, three.

There's so much to do and see.

Numbers, letters and objects too.

We can't wait to learn with you!

Song 2: We love to sing together,

in any kind of weather.

We dance and play our music,

and you can sing along.

CARE & MAINTENANCE

1. Keep the unit clean by wiping it with a slightly damp cloth.
2. Keep the unit out of direct sunlight and away from any direct heat sources.
3. Remove the batteries if the unit will not be in use for an extended period of time.
4. Do not drop the unit on hard surfaces and do not expose the unit to moisture or water.

TROUBLESHOOTING

If for some reason the unit stops working, please follow these steps:

1. Please turn the unit **OFF**.
2. Interrupt the power supply by removing the batteries.
3. Let the unit stand for a few minutes, then replace the batteries.
4. Turn the unit **ON**. The unit should now be ready to use again.
5. If the product still does not work, install a brand new set of batteries.

If the problem persists, please contact our Consumer Services Department, and a service representative will be happy to help you.

CONSUMER SERVICES

Creating and developing **VTech®** products is accompanied by a responsibility that we at **VTech®** take very seriously. We make every effort to ensure the accuracy of the information, which forms the value of our products. However, errors sometimes can occur. It is important for you to know that we stand behind our products and encourage you to call our Consumer Services Department with any problems and/or suggestions that you might have. A service representative will be happy to help you.

UK Customers:

Phone: 0330 678 0149 (from UK) or +44 330 678 0149 (outside UK)
Website: www.vtech.co.uk/support

Australian Customers:

Phone: 1800 862 155
Website: support.vtech.com.au

NZ Customers:

Phone: 0800 400 785
Website: support.vtech.com.au

PRODUCT WARRANTY/ CONSUMER GUARANTEES

UK Customers:

Read our complete warranty policy online at vtech.co.uk/warranty.

Australian Customers:

**VTECH ELECTRONICS (AUSTRALIA) PTY LIMITED –
CONSUMER GUARANTEES**

Under the Australian Consumer Law, a number of consumer guarantees apply to goods and services supplied by VTech Electronics (Australia) Pty Limited. Please refer to vtech.com.au/consumerguarantees for further information.

**Visit our website for more
information about our products,
downloads, resources and more.**

www.vtech.co.uk
www.vtech.com.au

